

# Palm Grove Court

King Edward Road, Thorne DN8 4EB

**19 Palm Grove Court**  
**£35,000**

**Contact**  
**01253-859000**

**Stately Marlborough**  
**36 x 12**



- Open Plan Lounge Kitchen
- Modern Kitchen
- Double Bedroom
- Large Bathroom with Shower over Bath
- Modern Gas Combi Boiler
- Well Maintained Gardens
- Concrete Sectional Shed
- UPVC Double Glazing
- Mains Gas, Water, Electric



**Head Office:**  
**Embra UK Ltd, 3 Victoria Road East, Thornton Cleveleys, Lancs. FY5 5HT**  
**Tel No. 01253-859000**  
**Email [embra@provider.co.uk](mailto:embra@provider.co.uk) Website [www.westshore.co.uk](http://www.westshore.co.uk)**

**A Member of the**  
**British Holiday**  
**& Home Parks**  
**Association**



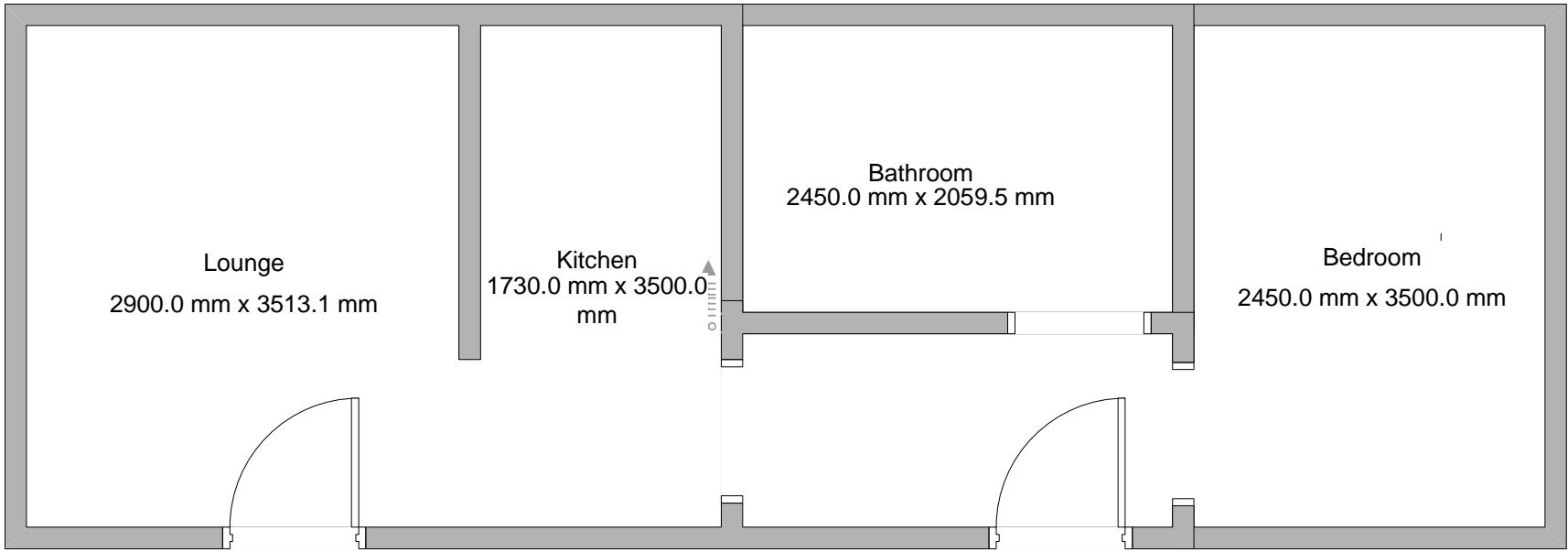

19 Palm Grove Court  
Stately Marlborough  
36x12

For illustration purposes only